

Installer and User Guide Non Programmable Thermostat for Floor Heating System OTH3600-GA

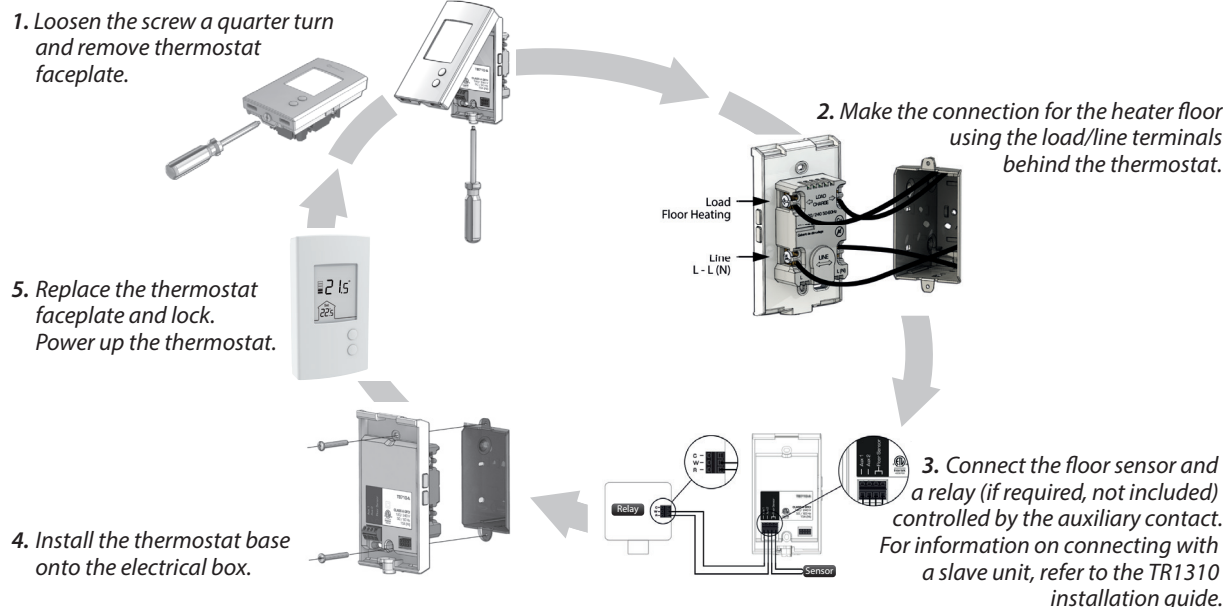

INSTALL YOUR THERMOSTAT



TECHNICAL SPECIFICATIONS

The OTH3600-GA non programmable thermostat is designed to control your floor heating system. The thermostat has an integral ground fault protection (Class A – GFCI) that can detect a leakage current of 5 mA and is equipped with an entry for connecting a temperature sensor which is supplied with the thermostat.

ABOUT YOUR THERMOSTAT

Your non programmable thermostat offers two (2) temperature control modes:

- **A Mode** : Ambient temperature control and possibility of limiting the temperature of the floor using an external temperature sensor.
- **F Mode**: Floor temperature control using an external temperature sensor and possibility of limiting the ambient temperature.

The OTH3600-GA also as an auxiliary contact that can function in 3 different modes. Possibility of controlling supplemental heat sources to be added by either using a slave module for heated floors or using a relay and a low-voltage transformer for an electric heater. The modes are set-up in the user settings.

- **SLA Mode** (A and F modes): Auxiliary contact for slave module. (TR1310 sold separately).
- **Shrt Mode**¹ (A mode only): Auxiliary contact on short cycle (15-second).
- **Fan Mode**¹ (A mode only): Auxiliary contact on long cycle (15-minute).

¹ The thermostat controls the ambient temperature using the heated floor. When the floor reach is maximum temperature or the floor is at 100% capacity and the ambient temperature is below the setpoint, the thermostat will close the auxiliary contact.

INSTALLATION

Installation must be carried out by a qualified electrician and must comply with local and national electrical codes in effect. To avoid risk of electric shock, disconnect all power suppliers to the main power panel before working on any circuit.

GROUND FAULT PROTECTION

The thermostat is equipped with a ground fault protection that can detect a leakage current of 5 mA. When leakage current is detected the ground fault protection is triggered and quickly interrupts the power supply to prevent any serious injuries.



RESETTING THE GROUND FAULT PROTECTION

The RESET button warning light flashes red when the ground fault protection is triggered. If the RESET button warning light comes on during normal operation of thermostat, simply reset the ground fault protection.

To reset the ground fault protection after the device is triggered, press the RESET button. The RESET warning light goes out. If for any reason this situation recurs, cut the power to the heating system from the main power panel and ask a qualified electrician to verify the installation.

TESTING THE GROUND FAULT PROTECTION

This test should be performed on a monthly basis to ensure the suitable operation of the ground fault protection.

1. Press the TEST button warning light: If the red RESET button warning light does not turn on, the test has failed. Cut the power to the heating system from the main power panel and ask a qualified electrician to verify the installation. If the warning light turn on, proceed to step 2.
2. Press the RESET button to restart the thermostat base.

USER SETTINGS

- To access the settings of the thermostat, lower the set point and press and hold the button \downarrow for 3 seconds to access the menu.
- Press the button \uparrow to change the setting.
- Press the buttons $\downarrow\uparrow$ simultaneously to select the next setting.
- Press and hold the buttons $\downarrow\uparrow$ simultaneously for 3 seconds to exit the menu and return to the normal display.

Settings display order

A Mode: 1, 2, 3, 4, 5, 9, 10, 11, 12.
F Mode: 1, 2, 6, 7, 8, 11, 12.

1. Temperature display format °C or °F, (°C by default).

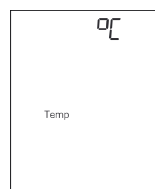

2. Select the control mode: A (ambient) or F (floor) (by default F).

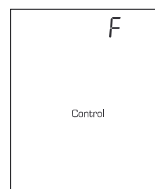

3. Assignment of auxiliary output SLA, Fan, Shrt (default SLA in A mode)



4. Minimum value of ambient temperature range (by default 5 °C).

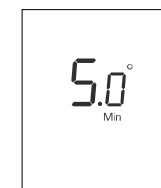

5. Maximum value of ambient temperature range (by default 36 °C).



6. Minimum value of floor temperature range (by default 5 °C).

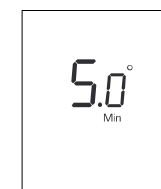

7. Maximum value of floor temperature range (by default 36 °C).



8. Maximum ambient temperature limit (5 @ 36 °C or OFF, by default in OFF position in F mode).



9. Minimum floor heating system limit (5 @ 36 °C or OFF, by default in OFF position in A mode).

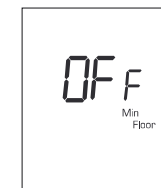

10. Maximum floor heating system limit (5 @ 36 °C or OFF, by default in OFF position in A mode).

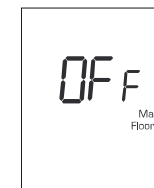

11. Floor sensor 10k or 12k (default 10k)



12. Backlighting (AUTO by default, active for 12 seconds when a button is pressed).



POWER FAILURE

Note: The following applies only if the thermostat was on for a minimum of 2 hours before the power failure occurred.

In case of power failure, the screen goes blank. The thermostat saves the settings and recovers the settings in place prior to failure after power is restored.

TROUBLESHOOTING

Error codes

- E1:** The thermostat temperature sensor is defective (open).
- E2:** The thermostat temperature sensor is defective (short circuit).
- OL:** The thermostat is overheated; make sure the load is less than 15 amperes.
- HH:** The thermostat temperature sensor has detected a temperature above the setpoint range (too hot).
- LL:** The thermostat temperature sensor has detected a temperature below the setpoint range (too cold).
- E1F:** The floor temperature sensor is defective or not connected (open).
- E2F:** The floor temperature sensor is defective (short circuit). Make sure there is no short circuit in the sensor connector.
- HHF:** The floor temperature sensor has detected a temperature above the setpoint range (too hot).
- LLF:** The floor temperature sensor has detected a temperature below the setpoint range (too cold).

TECHNICAL DATA SHEET

OTH3600-GA
Voltage: 120/208/240VAC, 50/60 Hz
Maximum load: 15A/1800W @ 120V, 15A/3120W @ 208V, 15A/3600W @ 240V
Temperature control range: 5 °C to 36 °C (41 °F to 97 °F)
Temperature display range: 0 °C to 70 °C (32 °F to 158 °F)
Resolution: 0.5 °C or 1 °F
Storage temperature: -20 °C to 50 °C (-4 °F to 122 °F)
Auxiliary contact: 0.1A @ 24VAC

This product must be installed with the floor sensor provided by the manufacturer.

WARRANTY

Three (3) year limited warranty. The manufacturer warrants the components of the OTH3600-GA against defects in material and workmanship for a three (3) year period from the date of purchase, under normal use and service, when proof of purchase of such is provided. The obligation of the manufacturer is limited to replacement of the product (device) only and in no way whatsoever includes the cost of connecting or installing the device or replacement parts.

CUSTOMER SERVICE

If you have any questions about this product, please contact our technical support team:

Ouellet Canada Inc.: 1 800 463-7043 • info@ouellet.com
www.ouellet.com

Momento: 1 866 930-7878 • www.momentoconfort.com

Global Commander: 1 855 247-5596 •
www.globalcommander.ca

180, 3^e Avenue, L'Islet (Québec) G0R 2C0 CANADA